

SITE PLAN FOR CHINESE CEMETERY OF STOCKTON

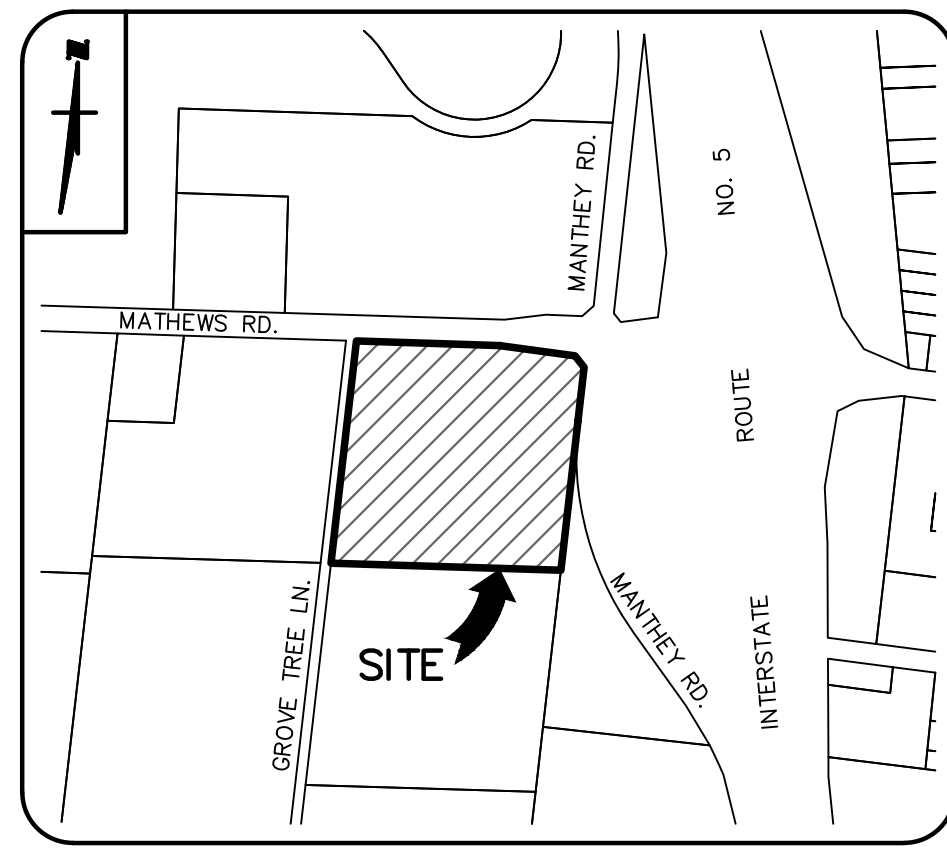

VICINITY MAP
NOT TO SCALE

EXISTING LEGEND

- AC DENOTES ACRES
- CV DENOTES CULVERT
- DI DENOTES DRAIN INLET
- DWY DENOTES DRIVEWAY
- EAS DENOTES EXISTING ACCESS EASEMENT
- E1 DENOTES TELECOMMUNICATION BOX
- E2 DENOTES CATV BOX
- E3 DENOTES PG&E BOX
- ELP DENOTES ELECTRICAL PANEL
- EX DENOTES EXISTING
- GV DENOTES GAS VALVE
- GW DENOTES GUY WIRE
- IRR1 DENOTES IRRIGATION BOX
- IRR2 DENOTES IRRIGATION VALVE
- PM DENOTES PUMP
- PP DENOTES POWER POLE
- S1 DENOTES NO PARKING SIGN
- S2 DENOTES STOP AHEAD SIGN
- S3 DENOTES BUS STOP SIGN
- S4 DENOTES STREET NAME SIGN
- S5 DENOTES STOP SIGN
- S6 DENOTES NO RIGHT TURN SIGN
- S7 DENOTES BULLETIN SIGN
- SDCB DENOTES STORM DRAIN CATCH BASIN
- SF DENOTES SQUARE FEET
- SP DENOTES SERVICE POLE
- SU DENOTES STORAGE UNIT
- TM DENOTES TELEPHONE MANHOLE
- WM DENOTES WATER METER BOX
- WV DENOTES WATER VALVE
- WW DENOTES WATER TANK & WELL

PROPOSED LEGEND

- LANDSCAPE
- TOTAL AREA: ±8,995 SF (±0.20 AC)
- CEMETERY PLOTS
- TOTAL AREA: ±128,671 SF (±2.95 AC)
- EXISTING PARKING SPACES
- PROPOSED PARKING SPACES (9' X 18')
- INCLUDING ADA PARKING SPACE
- TOTAL PARKING SPACES
- ASPHALT PAVEMENT
- AGGREGATE BASE

OWNER INFORMATION
 CONFUCIUS CHURCH OF STOCKTON
 212 E. LAFAYETTE STREET
 STOCKTON, CA 95203
 (209) 603-7277
 WAYNECHAN2013@GMAIL.COM

PROPERTY DATA
 STOCKTON CHINESE CEMETERY
 202 W. MATHEWS ROAD
 FRENCH CAMP, CA 95231
 APN: 193-190-13 & 14
 TOTAL AREA: ±9.94 ACRES

BASIS OF BEARINGS:

THE WEST LINE OF LOT 2 (EAST LINE OF PRIVATE ROAD), WHICH BEARS NORTH 6°07'20" EAST, AS SHOWN ON THE MAP RECORDED IN BOOK 33 OF SURVEYS, PAGE 188, SAN JOAQUIN COUNTY RECORDS.

BENCHMARK: C.O.S. 417

BRASS DISK MARKING CITY OF STOCKTON MONUMENT STAMPED "14S-30" IN MONUMENT WELL, LOCATED AT THE CENTERLINE OF MATHEWS ROAD AND NORTHBOUND ON-RAMP TO INTERSTATE HIGHWAY NO. 5.

ELEVATION = 17.10' (NAVD88)

SCALE 1" = 40'

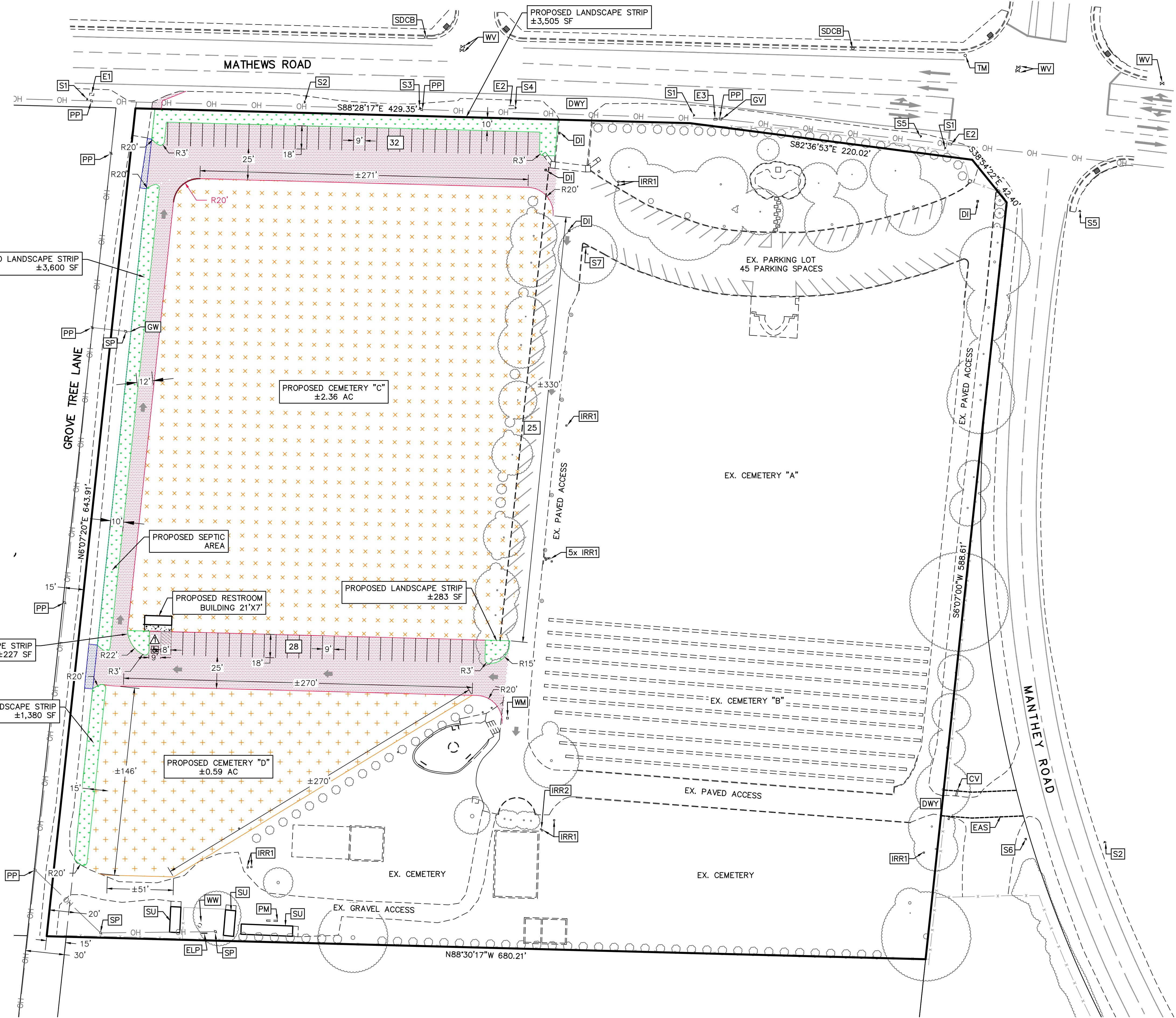
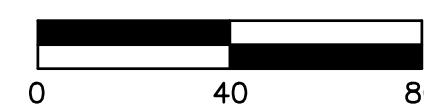

UNAUTHORIZED CHANGES AND USES:
 THE ENGINEER PREPARING THIS SITE PLAN WILL NOT BE RESPONSIBLE FOR, OR LIABLE FOR, UNAUTHORIZED CHANGES TO OR USES OF THIS PLAN. ALL CHANGES TO THIS PLAN MUST BE IN WRITING AND MUST BE APPROVED BY THE PREPARER OF THIS SITE PLAN.



REVISIONS			
NO.	DESCRIPTION	DATE	BY

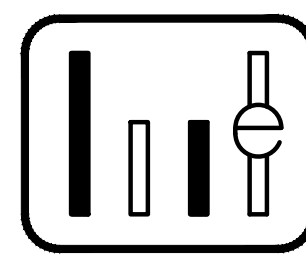

WONG ENGINEERS, INC.
 PLANNING ENGINEERING SURVEYING
 4578 FEATHER RIVER DRIVE, SUITE A
 STOCKTON, CALIFORNIA (209) 476-0011
 DATE 4/11/25

L.S. 7600
 R.C.E. 48717

JOB NO.: 3151
 DATE: APR. 2025
 SCALE: AS SHOWN
 DRAWN: NS
 DESIGN: ZCW/GC
 CHECKED: ZCW

202 W. MATHEWS ROAD

FRENCH CAMP CALIFORNIA

SITE PLAN

SHEET
 1
 OF ONE
 FILE 3151