

SITE

CODE ANALYSIS:
 THIS PROJECT SHALL COMPLY WITH THE FOLLOWING CODES:

CALIFORNIA:	
2022	CA. BUILDING CODE (CBC)
2022	CA. MECHANICAL CODE (CMC)
2022	CA. PLUMBING CODE (CPC)
2022	CA. FIRE CODE (CFC)
2022	CA. ELECTRIC CODE (CEC)
2022	CA. RESIDENTIAL CODE (CRC)
2022	CA. GREEN CODE (CALGREEN)
2022	CA. ENERGY CODE (CEMC)

CITY OF STOCKTON MUNICIPAL CODE:	
No.	PLAN INDEX
SP	SITE PLAN
G1.0	GREEN BUILDING STANDARDS
G2.0	GREEN BUILDING STANDARDS
BMP	BEST MANAGEMENT PRACTICES
A1.0	FLOOR & ROOF PLAN
A2.0	ELEVATIONS PLAN
E1.0	ELECTRICAL PLAN
S1.0	FOUNDATION & ROOF FRAMING PLAN
S1.1	FOUNDATION DETAILS
S1.2	ROOF FRAMING DETAILS
S1.3	GENERAL NOTES
P1.0	PLUMBING PLAN
PV0.0	COVER SHEET/SITE PLAN
PV1.0	PLAN VIEW
PV1.1	DETAILS
PV2.0	LABELS
PV3.0	SINGLE LINE

PROJECT INFORMATION

SITE ADDRESS:	3111 LEWIS ST STOCKTON, CA 95205
OWNER:	EFREN CASTRO
DESIGNER:	JUAN MONTERO (209) 380-4681 2538 WEST LANE, STE 3 STOCKTON, CA 95205
SCOPE OF WORK:	NEW ADU 2 BEDROOM AND 1 BATHROOM WITH ATTACHED GARAGE
BUILDING:	LAND USE: RESIDENTIAL
OCCUPANCY GROUP:	R-3/U
TYPE OF CONSTRUCTION:	V-B
SPRINKLERS:	NO
STORIES:	ONE
AREA OF WORK (SQ. FT.)	658 sq-ft (E) Living Space 650 sq-ft (N) Living Space (ADU) 520 sq-ft (N) Garage (ADU)

ADDRESS NUMBER SHALL BE PROVIDED IN A POSITION THAT IS PLAINLY LEGIBLE AND VISIBLE FROM THE STREET. THE ADDRESS NUMBERS SHALL CONTRAST WITH THEIR BACKGROUND AND BE A MINIMUM OF 4 INCHES HIGH WITH A MINIMUM STROKE WIDTH OF 1/8 INCH.

- SITES SHALL BE GRADED TO DRAIN SURFACE WATER AWAY FROM FOUNDATION WALLS. THE GRADE SHALL FALL A MINIMUM OF 6 INCHES WITHIN THE FIRST 10 FEET (6%).
- IMPERVIOUS SURFACES WITHIN 10 FEET OF THE BUILDING SHALL BE SLOPED A MINIMUM OF 1/4" PER FOOT (2%) AWAY FROM THE FOUNDATION.

CONTRACTOR MUST OBTAIN AN ENCROACHMENT PERMIT FOR ANY WORK IN THE RIGHT OF WAY.

NO.	REVISION	DATE

SITE PLAN

ADDRESS:
3111 LEWIS ST
STOCKTON, CA 95205
 OWNER:
EFREN CASTRO

DESIGNED:	NS	SHEET:
DRAWN:	JM	SP
CHECKED:	JM	
APN:	143-160-540	
DATE:	09 / 20 / 2025	
SCALE:	AS NOTED	

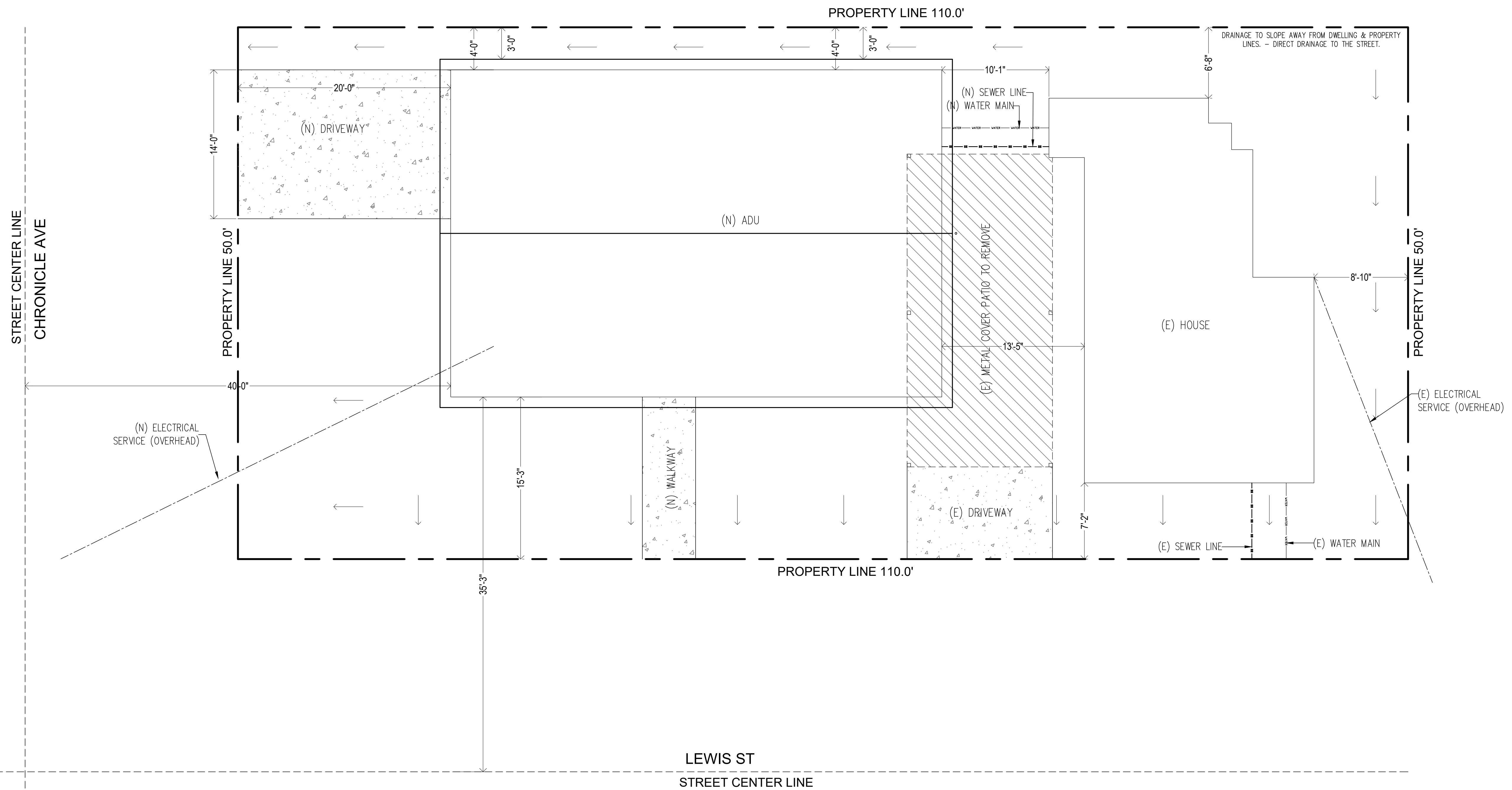

SITE PLAN
 3/16" = 1'-0"